

Introducing the Ultimate Defence  
Against Stored Product Moths.



## Gumtree SPP Diamond Trapp

India's First Glue-Based Stored  
Product Pest Moth Monitoring Device.

Stored product moths pose an expensive risk to dry food processing. Launched in April 2024, the SPP Diamond Trapp attracts and traps male almond moths (*Cadra cautella*), raisin moths (*Cadra figulilella*), and warehouse moths (*Ephestia elutella*) when paired with the right pheromone lure.

## Key Benefits & Features



### Non-Toxic & Environment-Friendly

100% glue-based and pesticide-free, making it perfectly safe for sensitive food environments.



### Highly Effective

Detects moth presence early, even in low pest populations.



### Durable

Built to remain completely effective over a full 2-month period (8 weeks).



### Space-Saving & Compact

Designed for versatile placement in structures with tight, limited space.



### Ideal for food industry

Ideal for warehouses, retail store back areas, dark undisturbed spaces, and processing areas for spices, nuts, dry fruits, chocolates, pet foods, grains and other dry foods.

## Product Specifications Table

Target Pests:	Almond Moth, Raisin Moth, Warehouse Moth.
Color:	White, Green & Yellow.
Dimensions:	26.5 cm x 18 cm x 2 cm.
Adhesive Surface:	46 cm x 16 cm.
Trap Weight / Material:	58g ( $\pm 3g$ ) / Premium Paperboard and Glue.
Glue Weight:	7g.

## Step-by-Step Installation Instructions

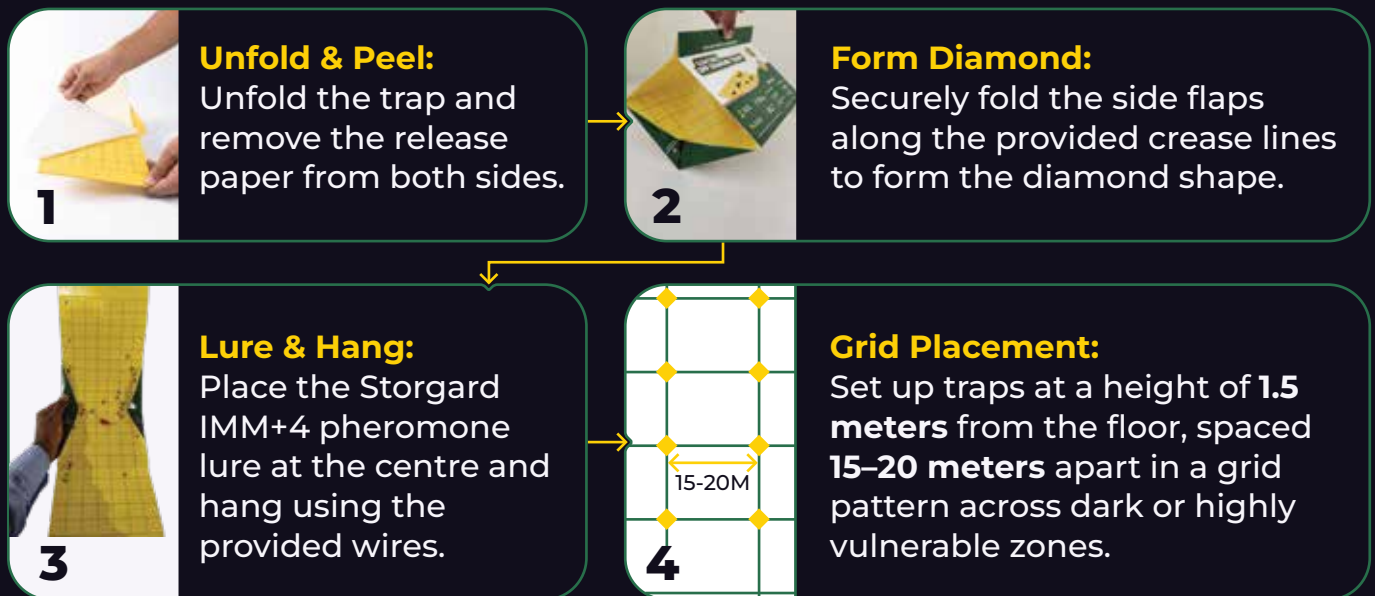

## Monitoring & Maintenance Guidelines:

Check traps weekly and record insect counts on the data table printed on the trap exterior.

Increase counts to twice weekly or daily if an outbreak or heavy product infestation is suspected.

Replace both the trap and pheromone lure every **8 weeks**.

Supplied in box of 25 traps all over India.

Contact Giridhar Pai Associates LLP for distributor details and orders.

[contact.gpa@giridharpaiassociates.com](mailto:contact.gpa@giridharpaiassociates.com)

[www.giridharpaiassociates.com](http://www.giridharpaiassociates.com)